

Cable routing plan

Product name: Katherm QE UL

Version number: 01



**Genau
mein
Klima.**

KAMPMANN

Information on cable laying:

The following information on cable types and cable laying must be observed in compliance with National Electric Code.

The installation, operation and maintenance of these devices must comply with the country-specific applicable laws, standards, regulations and directives.

Without *: NYM-J. The required number of cores incl. protective conductor is indicated on the cable. Cross sections are not indicated, as the cable length is included in the calculation of the cross section.

- *):
Shielded cable, J-Y(ST)Y 0.8mm. Lay separately from power lines.
- **):
Shielded cable stranded in pairs, e.g. UNITRONIC® BUS LD 2x2x0.22, UNITRONIC® BUS LD 3x2x0.22. Install separately from power lines.
- If other cable types are used, they must be at least equivalent.
- Lines for data or bus signals are shown with shield connected at one end. Lines for analog signals are shown with the shield not connected. Due to structural or local conditions and depending on the type and level of interference, which can be caused by magnetic and/or electric fields in high and/or low frequency ranges, among other things, a different connection of the shield (connected at both ends or not connected) may be necessary. This must be checked by the customer and, if necessary, carried out deviating from the specifications in the documentation!

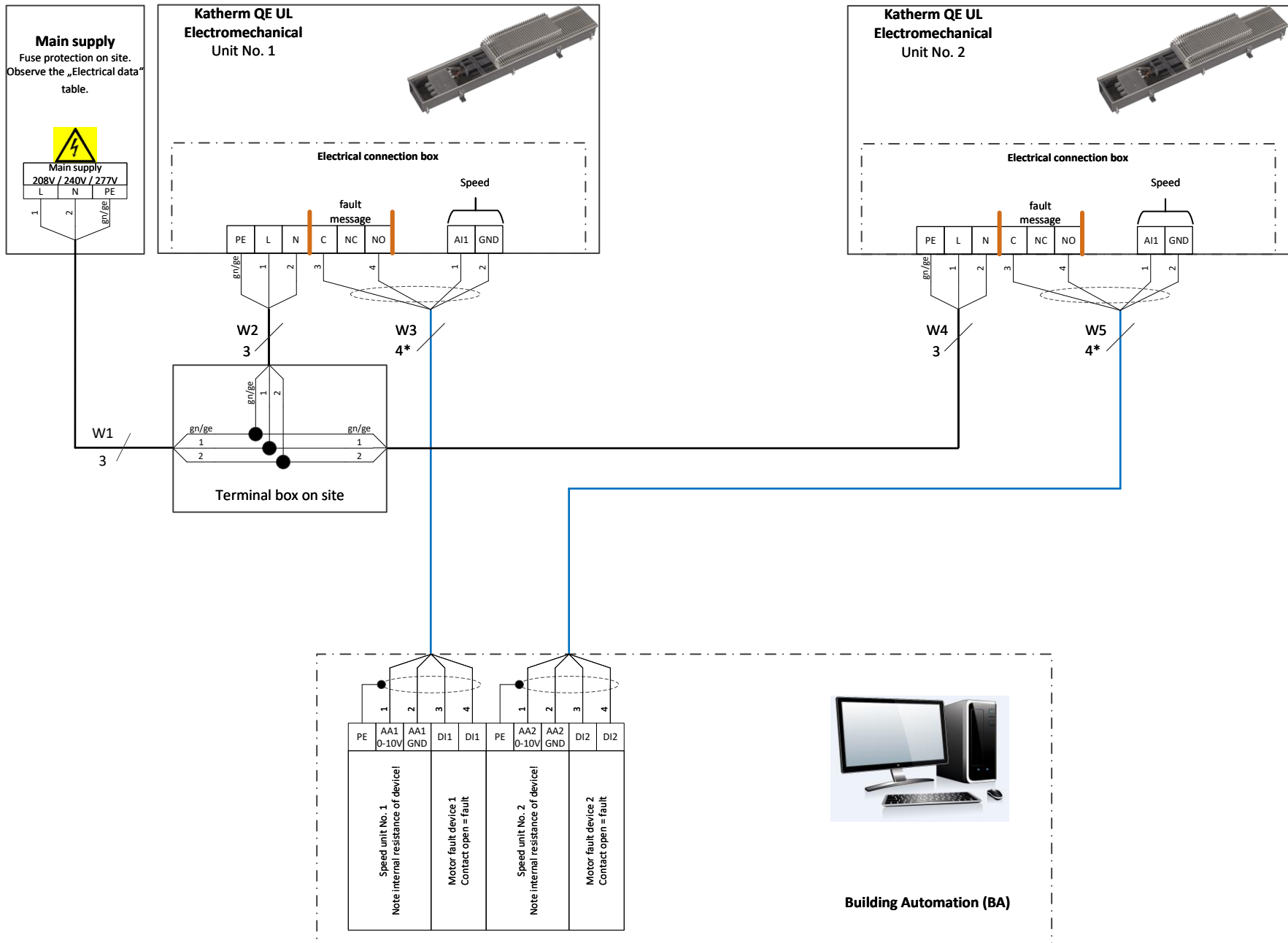

Bearbeiter:

Erstelldatum: 01.03.2024

Projekt: Katherm QE UL

Projekt-Nr.:

Katherm , UL-version,
Control 0-10V DC via GA

Blatt-Nr.:
3 von 5

KAMPMAN
Genau mein Klima.

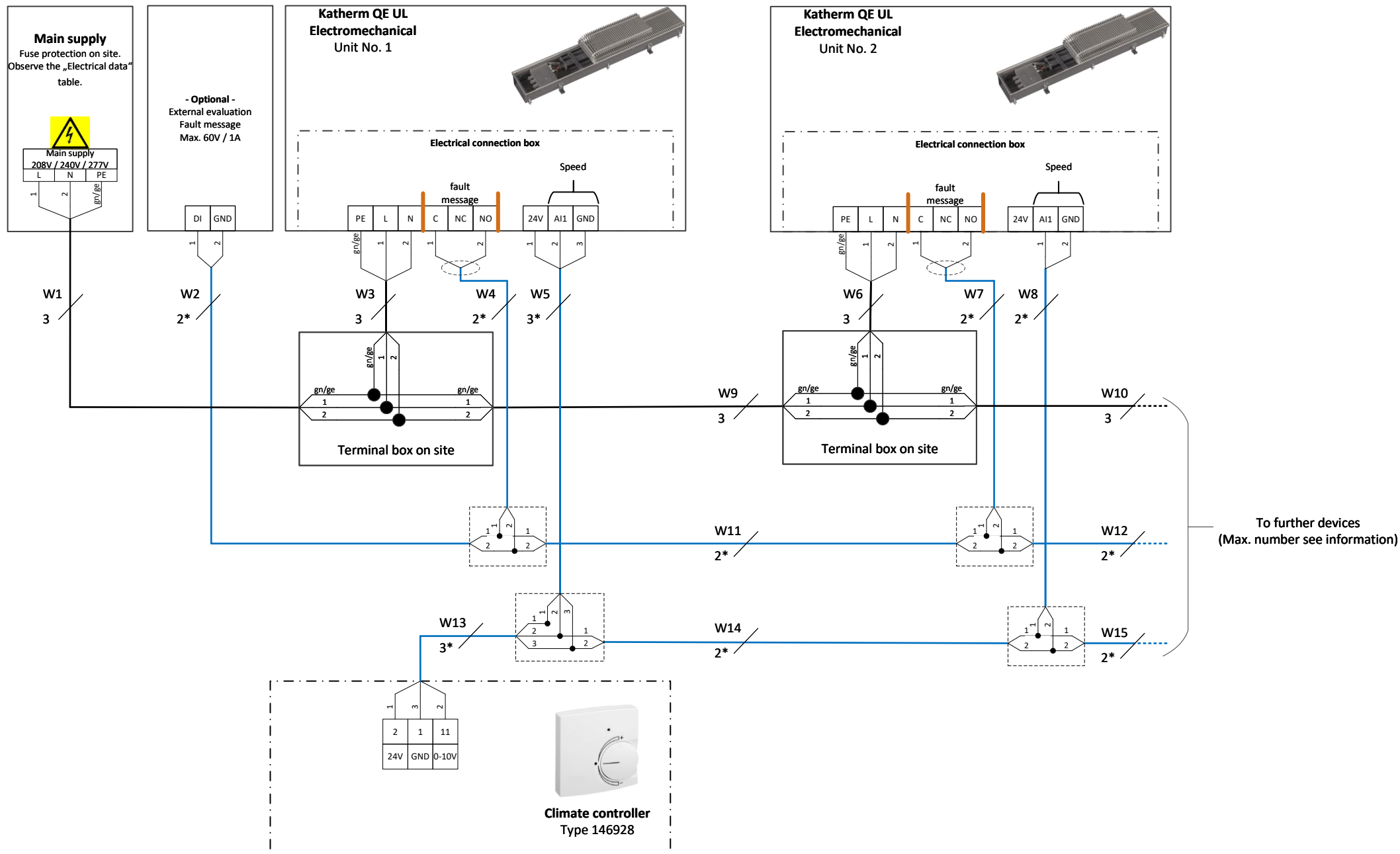

Bearbeiter:	Projekt: Katherm QE UL
Erstelldatum: 01.03.2024	Projekt-Nr.:

Katherm , UL-version,
Control via climate controller type 146928

Blatt-Nr.:
4 von 5



Kampmann GmbH & Co. KG
Friedrich-Ebert-Str. 128-130
49811 Lingen (Ems)

T +49 591 7108-0
E info@kampmann.de

kampmanngroup.com

